



Ultimate 4G LTE Trail Camera Instruction Manual



(Model: UML2)

Content

1 Camera Overview.....	3
2 Quick start guides.....	5
2.1 Installing the batteries	5
2.2 Installing the SD card.....	6
2.3 Insert Nano SIM card.....	7
2.4 Downloading the Mobile App.....	7
2.5 Power switch and buttons.....	8
2.6 Setting map.....	10
3 Connecting CAM to cloud server.....	15
3.1 Connecting CAM to cloud server.....	15
3.2 Setting CAM with Web Portal or APP.....	20
3.3 Other basic operation via APP	22
4 Auxiliary power.....	24
5 Mount tips	24
Appendix I : Technical Specifications	26
Appendix II : Parts List.....	28

What you will need to set this camera up:

-Internet Access to

<https://www.linckeazi.com>

-SD Card

-Nano SIM Card

This Camera is characterized by:

- 3K/1080P/720P H.264 Video,<0.6s video trigger speed
- 5MP/8MP/16MP/24MP/32MP Image Resolution
- 4G LTE
- LinckEazi Cloud Platform
- Free APP (Android&iOS)
- Multiple Cloud Remote Control Commands
- Easy Installation
- Adjustable Hi-Power IR Flash
- Maximum Silent Capture
- Location Support
- Video length: 5s-60s
- Photo Burst 1-10
- Diagonal Field of View(FOV)65°(16:9)
- Multi Zone PIR Sensor
- PIR Delay 0sec-60min

- Time Lapse(3Min-24hour)
- Up to 4 Work Time Settings
- 2.0" Color LCD
- SD Card Max to 512GB SD card (not incl)
- SD Overwrite
- Camo Color
- Wall Mount Fixation Threads
- Operation Temperatures -20°C ... +60°C
- Rechargeable Lithium-battery pack/ 12V external power

1 Camera Overview

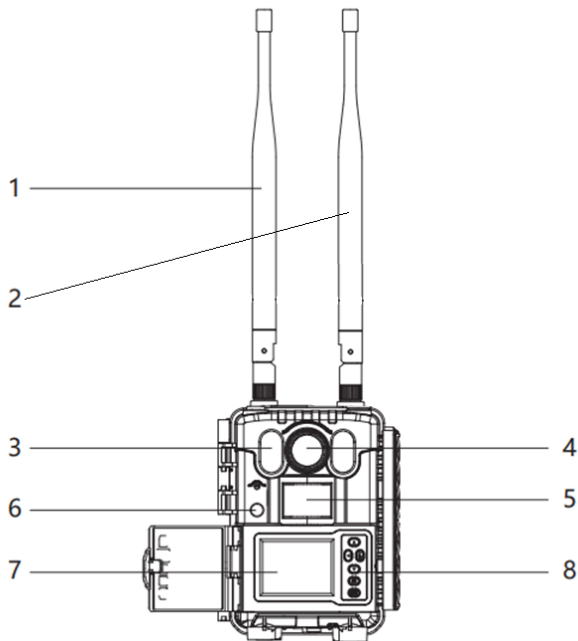

- 1, 2: LTE antenna 3: IR Led
4: Camera lens 5: PIR 6: Light sensor

7: Display screen

8: Key board

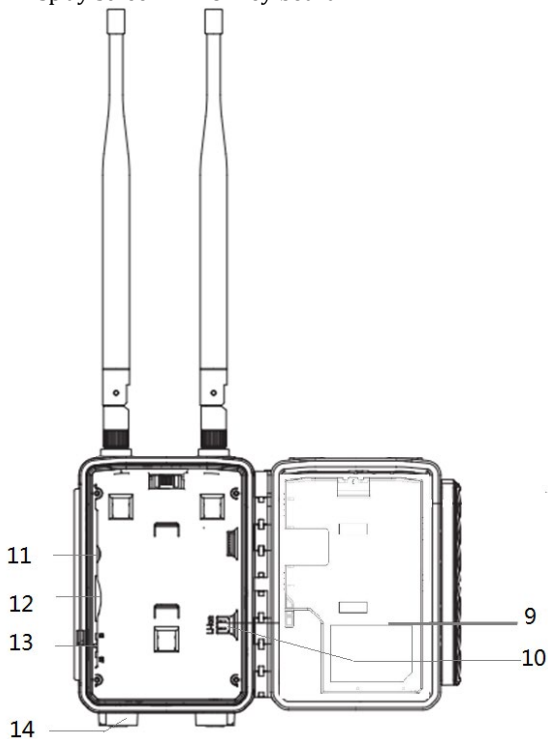

- 9: Battery pack cover 10: Battery interface
11: SIM slot 12: SD slot
13: Power Switch 14: External power jack

2 Quick start guides

2.1 Installing the batteries

Step1: Put the battery pack in the back housing and connect the battery pack with main board's power interface.



Step2: Tidy up the battery cable, then cover the battery cover.

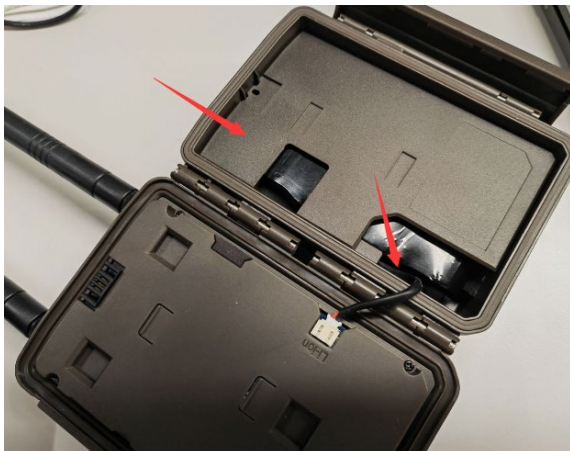

2.2 Installing the SD card

Insert the SD card as below direction.



Support max to 512GB SD card.

⚠️ Note: If the SD card is more than 32GB, please enter MENU->SYS->Format SD to format the SD card before use. Otherwise, the data stored in SD card will not be correct.

2.3 Insert Nano SIM card

The SIM card slot is next to the SD slot.

- Be sure that PIN code of the SIM card is OFF
- Secure that SIM card has enough money

2.4 Downloading the Mobile App

Search“**Linckeazi**”in your Google Play Store or Apple Store



Accessing the Web Portal:

Open your web browser to: <https://www.linckeazi.com>

You also can scan the QR code and install the APK file to your smart phone.



Android APP



IOS APP

2.5 Power switch and buttons

Slide the power switch to ON position, then you can start setting the CAM.

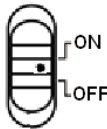

Fig2 Power switch

Power Switch:

OFF: Power off (Please remove batteries when not in use);

ON: Setting the camera;

Entering Working mode: Press **LEFT** button, then press **OK**.
(the screen will power off).

Buttons:

MENU: Enter menu

▲▼◀▶: Navigation button.

OK: Confirm operation

ATTENTION:

Video Playback is not available for this device; you could retrieve videos from the cloud platform or APP, or play videos from SD card.

2.6 Setting map

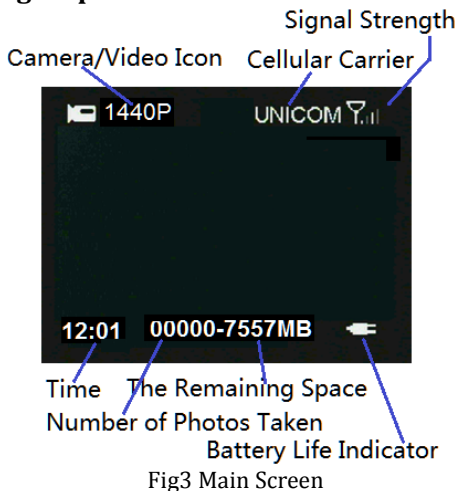

Settings:

NET	
4G LTE	On/Off
Sending Time	Instant/0:00/1:00/.../23:00
Setting Sync	Enter: Upload/Download
FW Update	No/Yes

Remote Control	Real Time/ Delay 0.5H/ 1H/ 2H/ 3H/ 4H/ 6H/ 12H/ 24H
----------------	---

Remote Control: You can remotely control your camera via mobile phone or web-portal. Choose **Real Time**, the wireless module will keep working, but the power consumption will be huge. **Delay 24H** means the wireless module will wake up after 24 hours even if there is no triggering. The **Delay** setting is for saving power.

Setting Sync: Upload means to sync the settings from your camera to cloud. **Download** means to sync the camera settings from cloud to your camera.

FW Update: Please do not unplug the batteries or external power when updating. Please make sure the batteries have more than 80% energy left when updating.

CAM	
Camera Mode	Photo/Video/ Photo+Video
Photo	
Photo Size	5MP /8MP/16MP/24MP/32MP
Photo Burst	1-10
Send Option	Single /Multiple (Multiple: It will sent the first 3 thumbnails)
Flash Power	Low/ High
Video	
Video Size	720,1080,3K
Video length	5-60s, 10
Flash Power	Low/ High
Photo+Video	
Photo Size	5MP /8MP/16MP/24MP/32MP
Photo Burst	1-3
Video size	720 ,1080,3K
Video length	5-60s, 10
Send Option	Single /Multiple (Multiple: It will sent 3 thumbnails and the first frame of the video)

Flash Power	Low/ High
-------------	------------------

Photo Burst: It's the number of pictures that to be taken of each triggering. If photo burst is 3, it means the camera will take 3 pictures after one triggering.

PIR	
Trigger Mode	PIR/Time Lapse/ Both
PIR Sensitivity	Normal /High/Low
PIR Interval	0s -60m
Time lapse	3Min~ 24 hours
Work Time 1~4	Off /On

PIR Interval: It means the time interval that the PIR sensor allowed to work. This prevents the card from filling up with too many redundant images.

Time Lapse: When choosing time lapse, camera takes photos or videos even when it is not triggered by a nearby

live animal. It's useful for constant monitoring of an area.

Work Time: The camera can work at a preset time and preset days. In the rest of the time the camera is not work. Work hour: 00:00-00:00 means 24 hours. If the settings is cross the day, for example: Start: 20:00 Stop: 10:00 means 00:00-10:00 AM and 20:00-24:00 of the chosen day.

SYS	
Set Clock	Enter
Password	Off/On
Over Write	Off/On
Format Card	Enter
Diagnose	Enter
FW Version	Enter
4G Info	Enter
Language	English/Suomi/Deutsch/Norwegian/Svenska

Default	Enter
---------	-------

Password: Make sure you write down your password or save it to your mobile phone so you can access your camera if you ever forget your password.

Diagnose: If the camera can't work properly, please choose **Diagnose**. The camera will generate a log file folder in your SD card. Please send all the files in log folder to FAQ for help.

3 Connecting CAM to cloud server

3.1 Connecting CAM to cloud server

In order to send your photos to your cloud account or mobile phone, you need to add your camera to your cloud account before use.

Open website: <https://www.linckeazi.com>. Or Linckeazi APP. Please scan the below QR code to install the APP.



Android APP



IOS APP

Login your account:

Login if you already have an account, or simply register one with your email account.

Username/Email *

Password *

Remember Me

Log In

[Forgot password?](#)

New users please [sign up](#) .

Username *

Email *

Email Address Verification Code *

 Get Verification Code

Set Password *

Confirm Password *

I agree to [Terms&Conditions](#)

For existing accounts, please **LOG IN**

Sign Up

Fig 4 Login via web portal

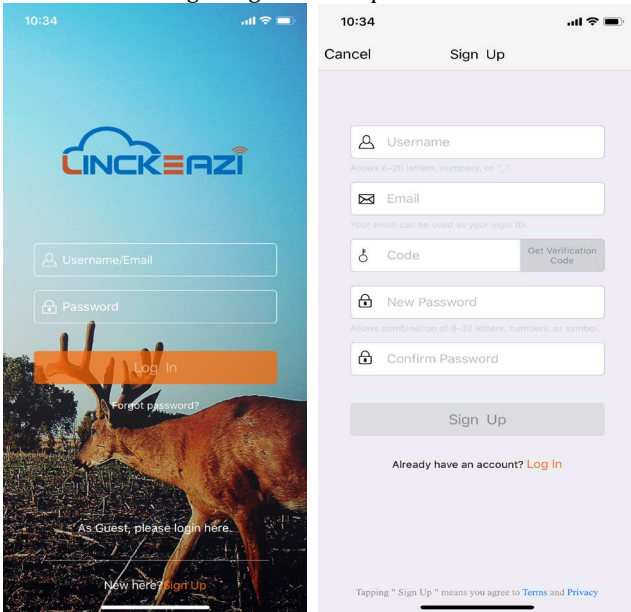

Fig 5 Login via Linkeazi APP

Add Device:

Please note: The camera needs to be added in your cloud account before use.

Name your camera; input the SN and IMEI of your camera. Add location description if necessary. **The SN and IMEI are labeled inside the camera.**

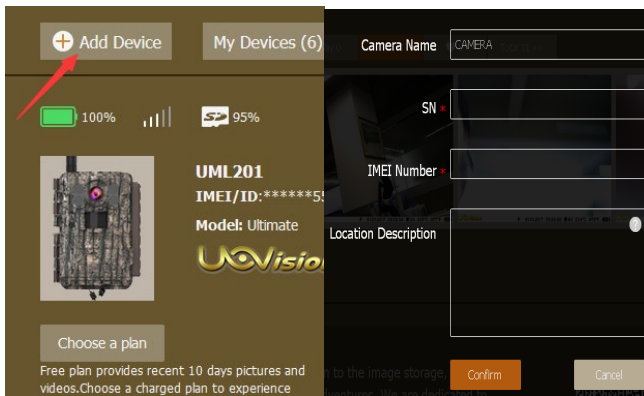

Fig 6 Add camera via web portal

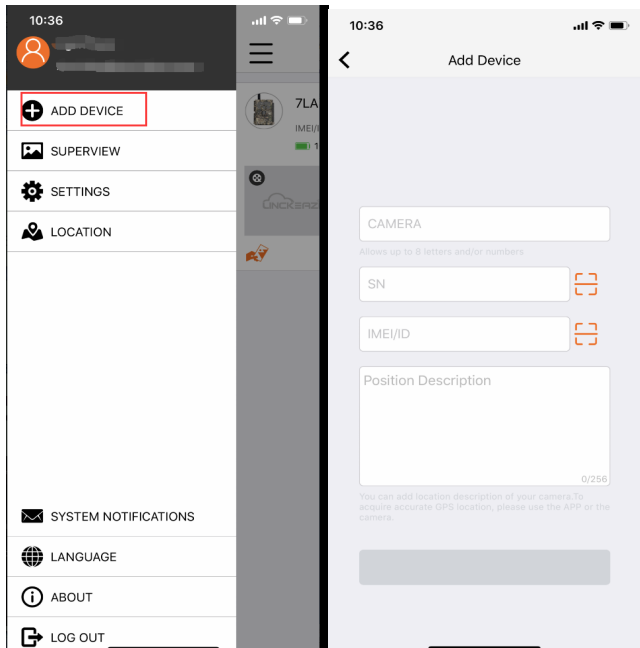

Fig 7 Add camera via APP

3.2 Setting CAM with Web Portal or APP

The CAM is easy to set through Web Portal or APP.

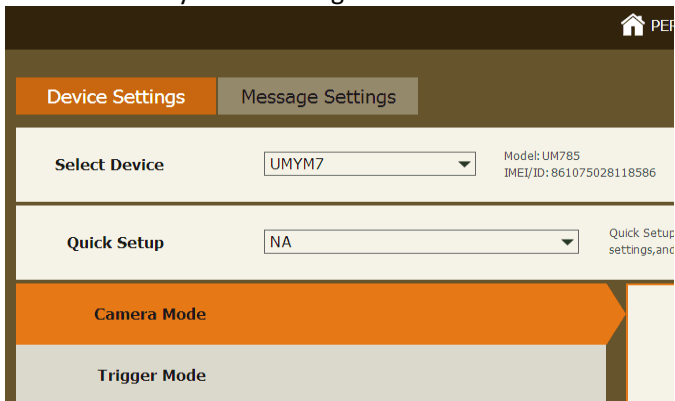

Fig 8 Device Settings via web portal



Fig 9 Device settings via APP

3.3 Other basic operation via APP

Take a photo

Retrieve a photo or video clip instantly

Get location

Get the location of your camera

Camera settings

Change the settings of your camera

Camera Status

Show the status of your camera

Request HQ photos or Videos

Request HQ photos or Video Clips from your camera.

Camera Status

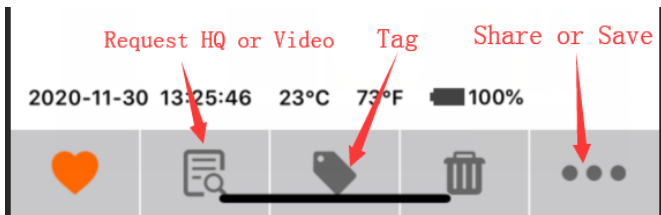
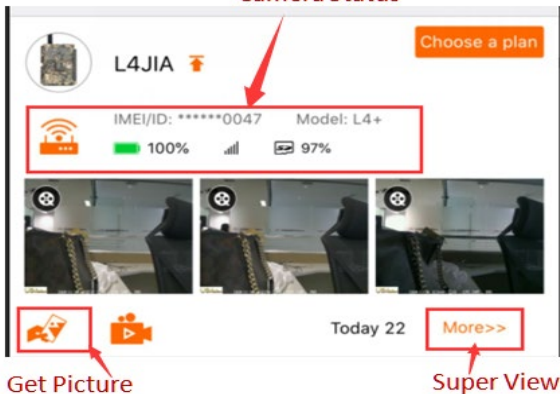

Fig 11

4 Auxiliary power

Your camera comes with an Auxiliary power jack. If you want to hook up an external 12V battery to power the camera, you can. The jack necessary to make the connection is a standard 4mm jack.

5 Mount tips

For best results, mount the camera approximately 1-1.5 meter off the ground and 3-15 meters. To enhance the flash, we recommend positioning the camera in an area with a backdrop to reflect the maximum amount of light.

Note:

- a. **The sun should not be shining directly on the face of the camera.**

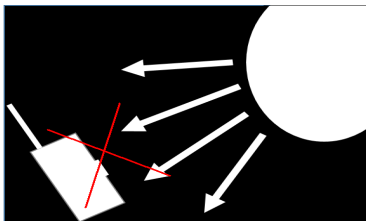

Fig 12

- b. Reflect with trees or other things to add more light to your target.**

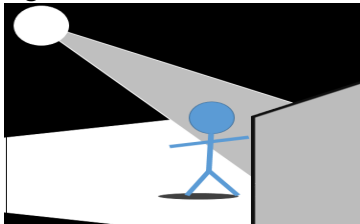

Fig 13

- c. Avoid placing the camera where the air flow is surging or too much vegetation. False triggers most occur on sunny, breezy days. When the wind moves the vegetation, the camera detects this and cannot distinguish it from a warm-blooded animal moving through the scene.**

Appendix I : Technical Specifications

Picture Resolution 5MP(Real Sensor)/8MP/16MP/24MP/32MP

Lens F/NO=1.85 (Field of View)=65°

Frequency Bands:

For Europe:

FDD-LTE: B1/B3/B5/B7/B8/B20/B28;

GSM: B2/B3/B5/B8

For North America:

FDD-LTE: B2/B4/B5/B12/B13/B14/B66/B71;

Flash Power Full, Low

Display Screen 2.0" LCD

Memory Card Max to 512GB(Class 10)

Video Resolution

3K,1080P, 720P

PIR Sensor Multi Zone

PIR Sensitivity Adjustable(High/Normal/Low)

Video Trigger Time <0.6S

Operation/Storage Tem. -20 - +60°C / -30 - +70°C

Trigger Interval 0s – 60 min.

Time lapse: 3min-24hours

Photo Burst 1–10

Video Length 5s–60s

Power Supply Rechargeable Lithium battery Pack; DC 12V.

Stand-by Current < 0.15 mA (<6mAh/Day)

Low Battery Alert LED Indicator, Cloud Platform

Mounting Rope/Belt/Python lock

Dimensions 130mmX104mmX69mm

Operation Humidity 5% - 90%

Security authentication FCC,CE, RoHS

Appendix II : Parts List

Part Name	Quantity
Digital Camera	One
Antenna	Two
Belt	One
DC adapter(EU/NA version)	One
Lithium Battery connection wire	One

Declaration of Conformity to Directive 2014/53/EU

CE Caution:

Hereby, the manufacturer declares that this camera is in compliance with the essential requirements and other relevant provisions of Directive 2014/53/EU. Please ask for your distributor for a copy of the Declaration of Conformity to Directive 2014/53/EU.



WARRANTY

The camera manufacturer provides 12 months of warranty service for this product against manufacturing defects or malfunctions. If your camera fails to function under normal use within 1 year, the camera manufacturer will repair or replace the camera at no charge. The purchase receipt must be included from an authorized retailer to validate the warranty. Improper use of the camera resulting in damage is not covered by this warranty.

The camera manufacturer can provide repair service, after the warranty expiration. The customer will be responsible for any charges on parts, labor and shipping costs. Please contact the manufacturer for more details. Please contact the area dealer for more details.